



## Shetland Court

**£380,000**

Situated in a sought after development off Page Street is this well proportioned two double bedroom two bathroom ground floor garden flat. The property comprises of a master bedroom with fitted wardrobes and en-suite shower room, a further double bedroom, large family bathroom. in addition to a spacious living area with direct access onto a private patio and communal gardens. the kitchen is fully equipped and the flat is well maintained throughout. Further benefits include secure gated parking, close to local amenities and transport links. Sole Agent.

### Viewing

Please contact our London Office on 020 8959 0011 if you wish to arrange a viewing appointment for this property or require further information.



2



2



1



## Floor Plan

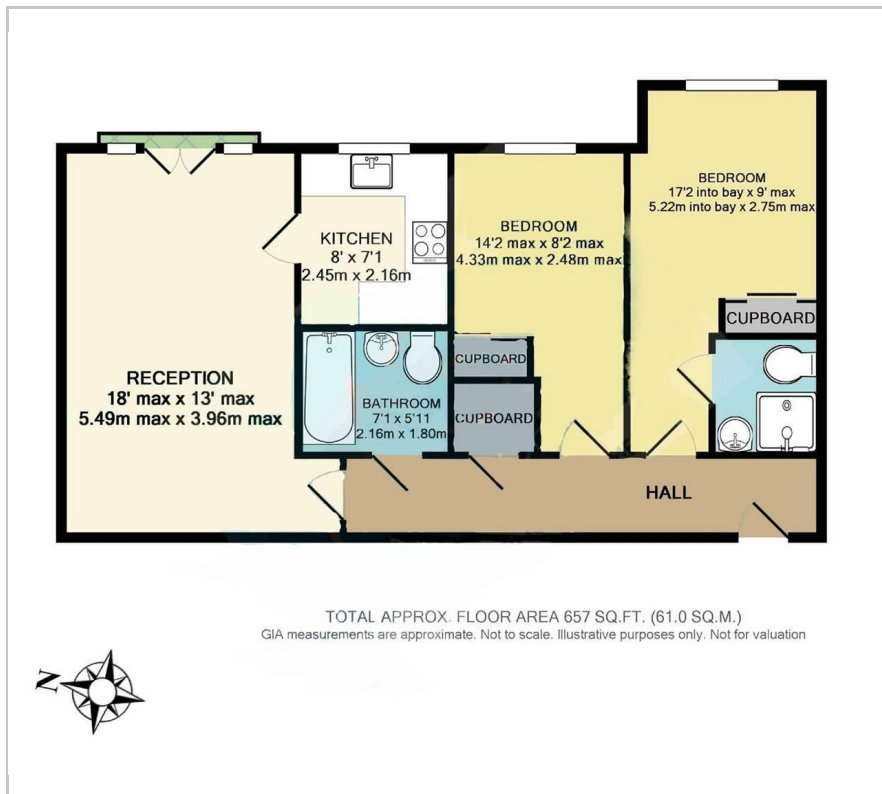

## Area Map

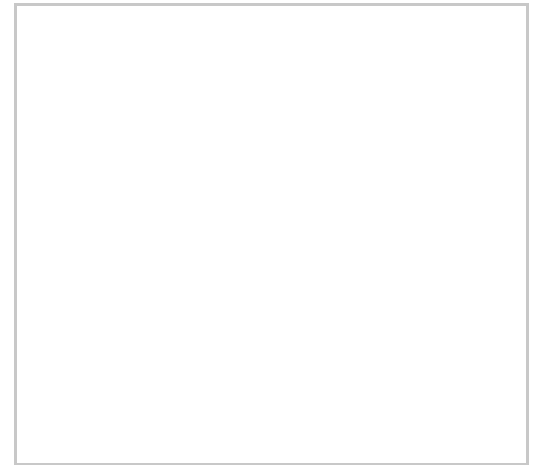

## Energy Efficiency Graph



These particulars, whilst believed to be accurate are set out as a general outline only for guidance and do not constitute any part of an offer or contract. Intending purchasers should not rely on them as statements of representation of fact, but must satisfy themselves by inspection or otherwise as to their accuracy. No person in this firm's employment has the authority to make or give any representation or warranty in respect of the property.